

CR 20 CX/CR 20 CX D

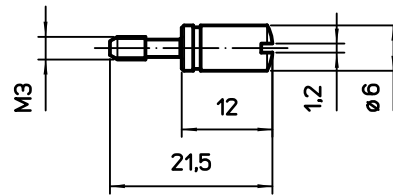

APPLICATION WITH SINGLE INSERT

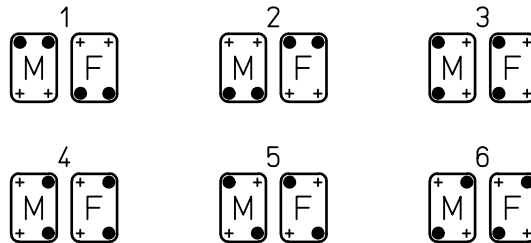

APPLICATION WITH DOUBLE INSERTS

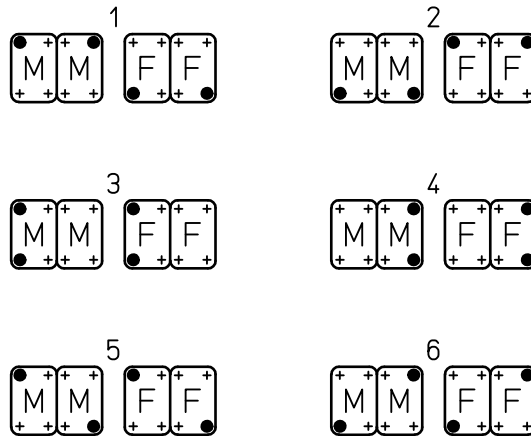

- CR 20 CX/CR 20 CX D coding pin
- + normal fixing screw
- M male insert
- F female insert

Diritti riservati All rights reserved

REV.	DATE	SIGNATURE

Dimensions
in mm

Simplified representation with dimensions without tolerance

Original Size A4

Date 27/05/21

Sign. S. Diasparra

CR 20 CX/CR 20 CX D

Single coding pin, MIXO inserts only, for 6 codings, stainless steel or zinc plated steel (D)

Scale

1:1

